



The Oasis



QLD KIT HOMES

Affordability Without Compromise

Welcome to "The Oasis," a splendid dwelling offering the epitome of comfort and style. This three-bedroom, two-bathroom haven boasts a generous 25.3x14.4-meter footprint, providing ample space for your family's needs. Beyond the inviting interior, "The Oasis" beckons you to embrace the outdoors with its expansive and captivating outdoor entertainment area. Discover the perfect blend of indoor luxury and outdoor allure in "The Oasis," where every day feels like a vacation.

3 
2 
363 m² 

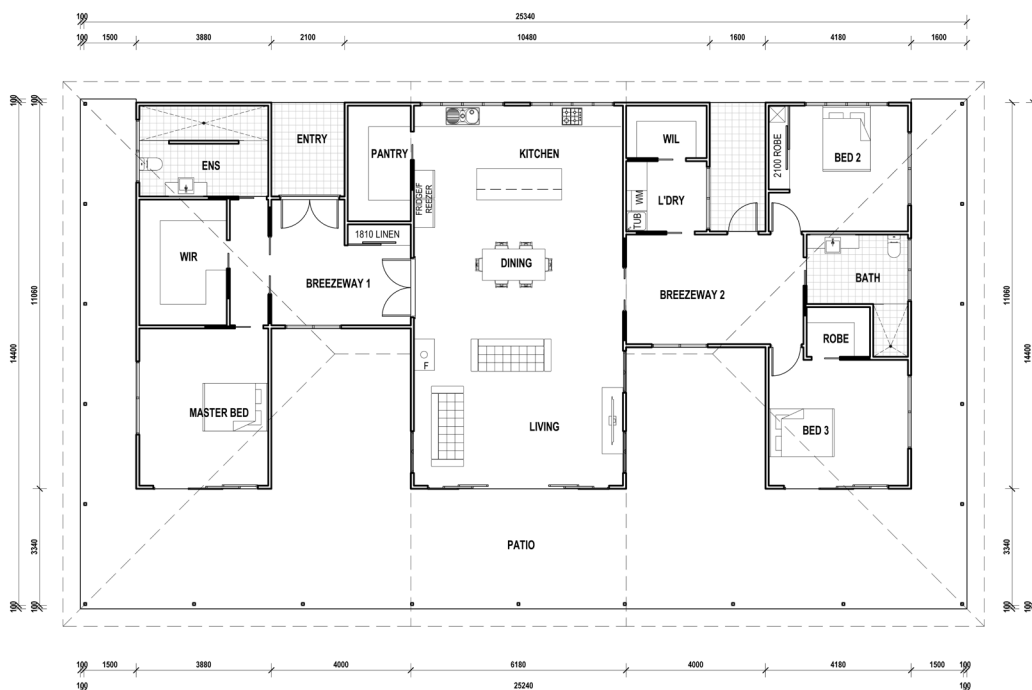

34/5 FACULTY CLOSE, SMITHFIELD | PH: (07) 4038 3900 | FAX: (07) 4027 9613
www.qldkithomes.com.au | QBCC: 1117525