

The Forest Falls



QLD KIT HOMES

Affordability Without Compromise

Discover the enchanting "Forest Falls," an exquisite haven that epitomizes spacious luxury. Boasting four bedrooms and two bathrooms within its expansive 20.8x17.8-meter layout, this residence offers ample room for both relaxation and entertainment. The true gem of "Forest Falls" lies in its sprawling outdoor entertaining area, a picturesque space destined for unforgettable gatherings or peaceful moments amidst nature's embrace. Experience the fusion of comfort and charm at "Forest Falls," where the allure of outdoor living meets the elegance of a well-appointed home.

4 

2 

330 m² 

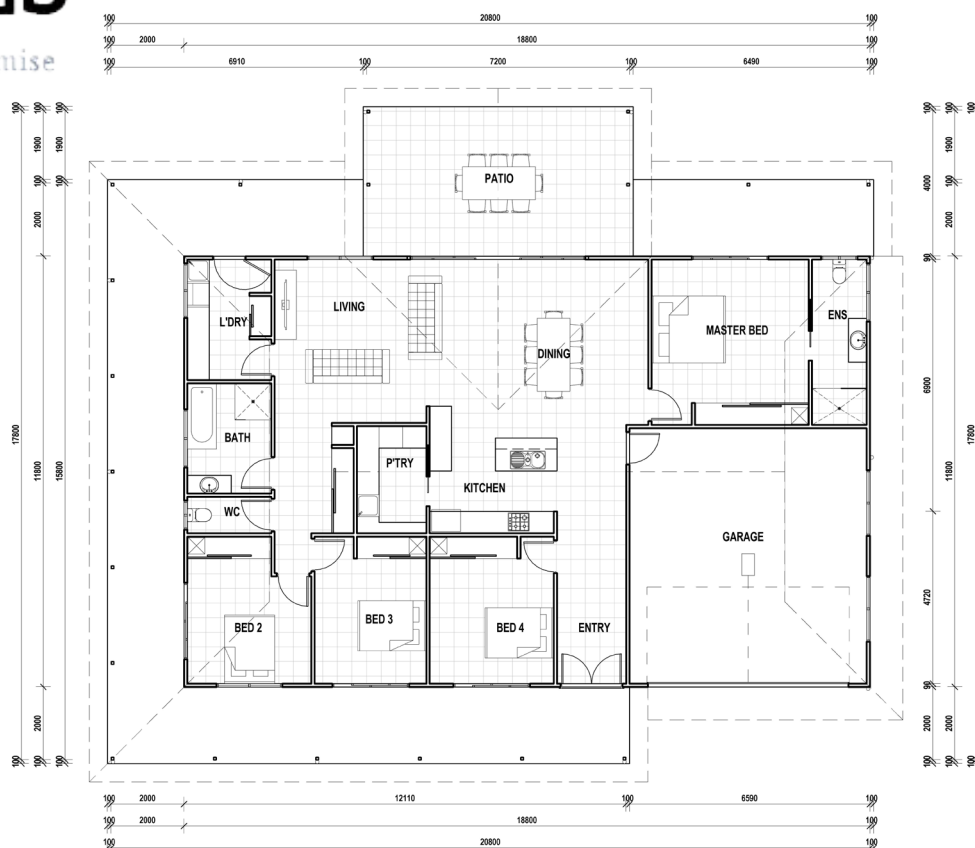

34/5 FACULTY CLOSE, SMITHFIELD | PH: (07) 4038 3900 | FAX: (07) 4027 9613
www.qldkithomes.com.au | QBCC: 1117525