

# The Carrington Residence



## QLD KIT HOMES

Affordability Without Compromise

The Carrington Residence is a modern two bed, one bath home and features open plan living opening to a large deck. This home measures 23x14.8m with large overhangs to all sides of the building. Making this a perfect home to retire to.

2   
1   
137 m<sup>2</sup> 

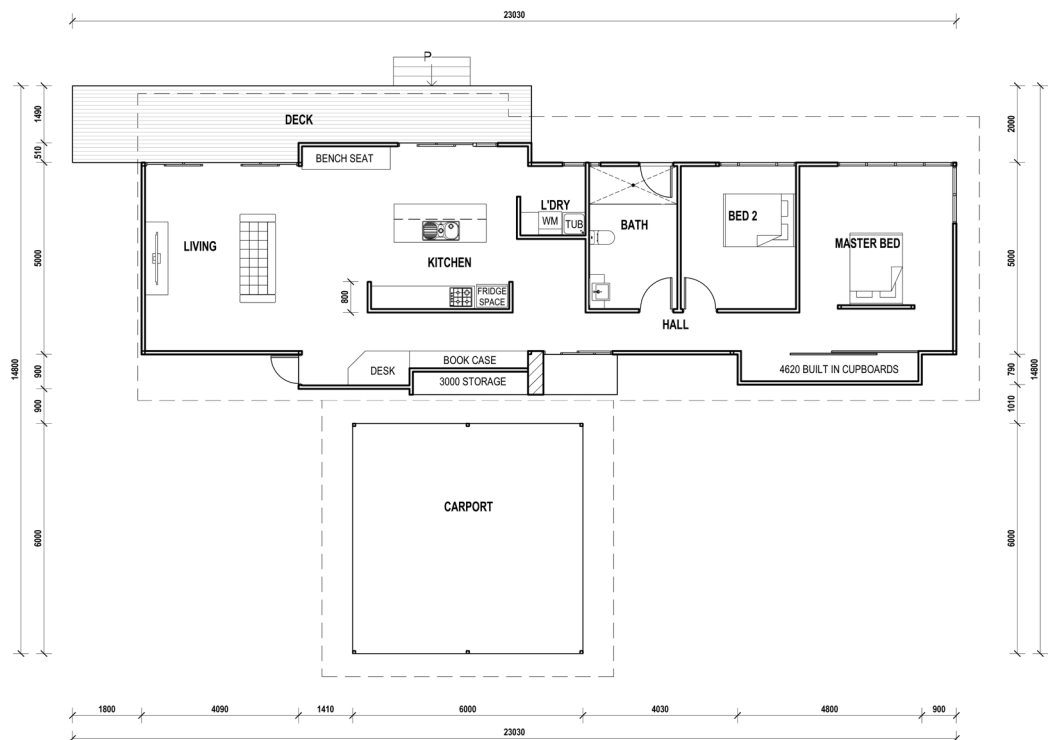

34/5 FACULTY CLOSE, SMITHFIELD | PH: (07) 4038 3900 | FAX: (07) 4027 9613  
www.qldkithomes.com.au | QBCC: 1117525