

The Getaway



QLD KIT HOMES

Affordability Without Compromise

The Getaway is a one bed, one bath home featuring a 2.4m wide patio at the front, with an open plan living area. This home measures 7.2x9m plus 600mm overhangs to all sides of the building. Making this a perfect weekender or granny flat.

1 
1 
65 m² 

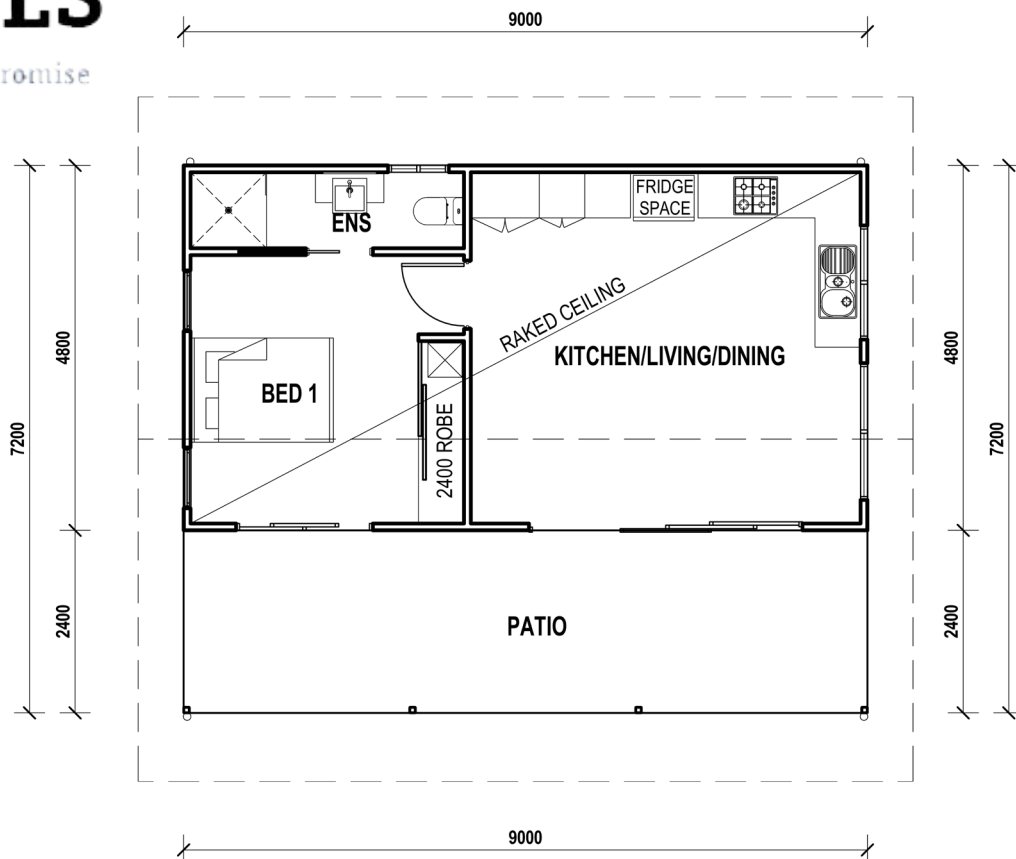

34/5 FACULTY CLOSE, SMITHFIELD | PH: (07) 4038 3900 | FAX: (07) 4027 9613
www.qldkithomes.com.au | QBCC: 1117525