

The Cottage



QLD KIT HOMES

Affordability Without Compromise

The Cottage is a one bed, one bath home with an open plan living area in a compact design with a walk in robe. This home measures 7x8m plus 600mm overhangs to all sides of the building. Making this a perfect first home or granny flat.

1

1

56 m²

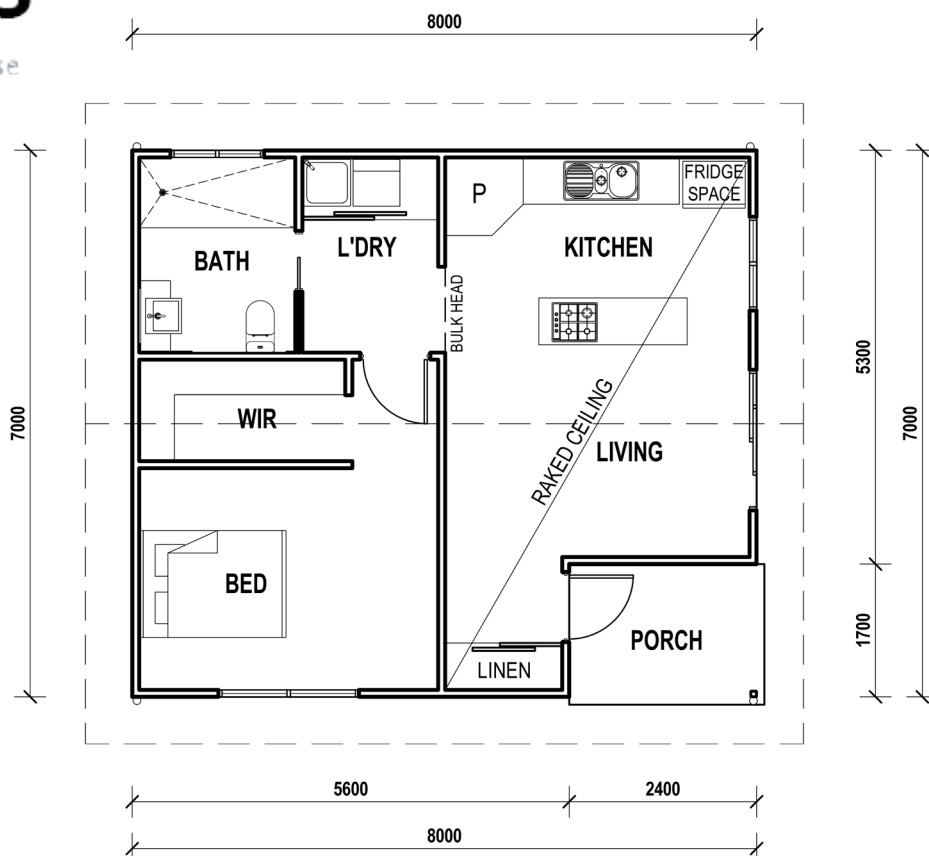

34/5 FACULTY CLOSE, SMITHFIELD | PH: (07) 4038 3900 | FAX: (07) 4027 9613
www.qldkithomes.com.au | QBCC: 1117525