

The Lakeside 208



QLD KIT HOMES

Affordability Without Compromise

The Lakeside is a four bed, two bath family home that features a 3m wide patio at both the front and back, with an open plan living area. This home measures 17.8x13.5m plus 600mm overhangs to all sides of the building. Making this a perfect family home with plenty of room.

4 

1 

208.5m² 

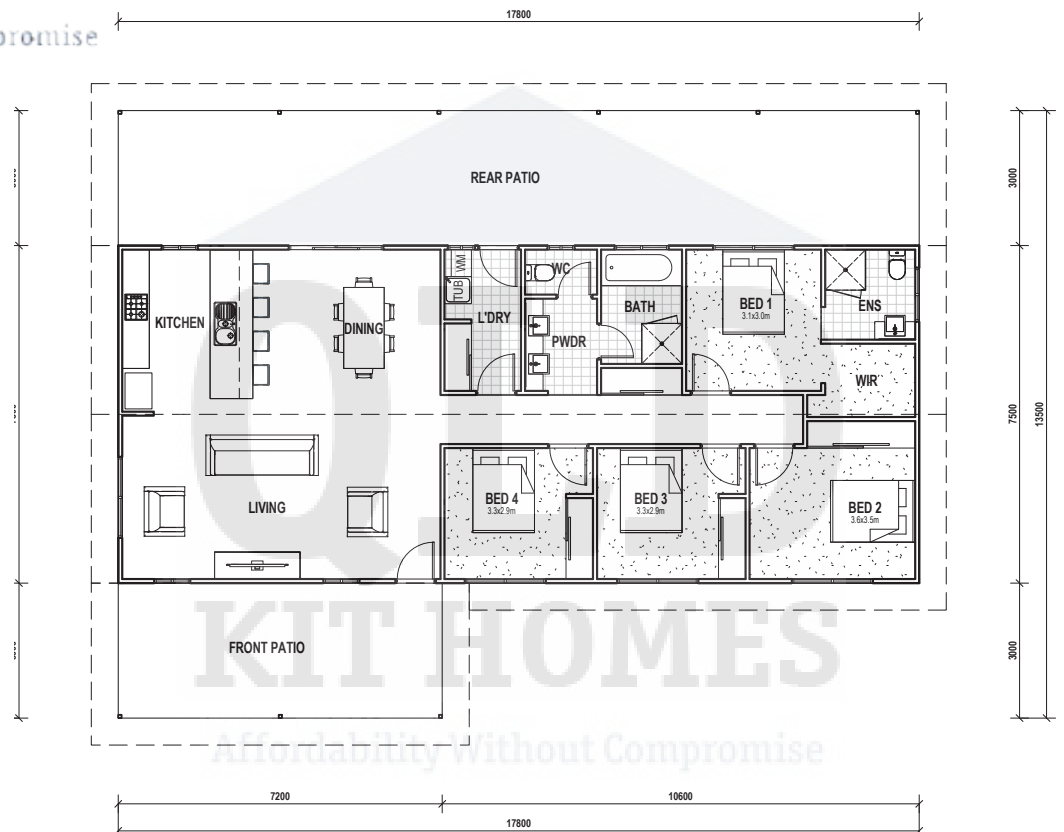

34/5 FACULTY CLOSE, SMITHFIELD | PH: (07) 4038 3900 | FAX: (07) 4027 9613
www.qldkithomes.com.au | QBCC: 1117525