

Affordable Luxury Living



Forest Cottage

From \$198,000 on slab
From \$245,000 elevated

- 3 bedrooms
- 1.5 bathrooms
- Open indoor/outdoor living
- Walk-in robe
- rear timber deck
- 185.66m² floor space



Modern Kitchen Appliances



Custom Finishes



Luxurious bathroom

Floor Areas	
Living	96.29m ²
Garage	5.91m ²
Patio	43.47m ²
	185.66m ²

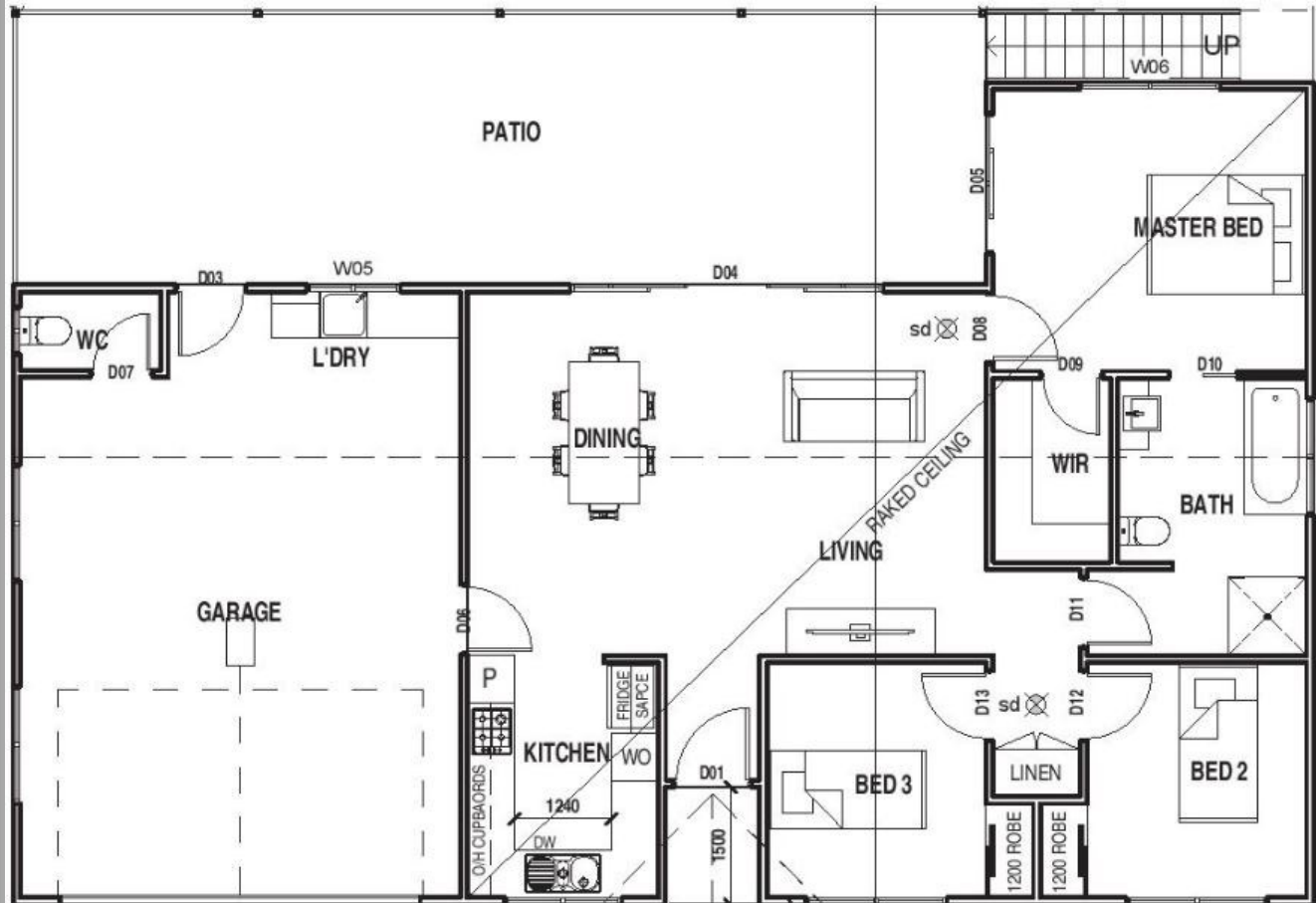

This drawing is copyright ©

**QLD
KIT HOMES**
Affordability Without Compromise

Shop 34 Campus Village
5 Faculty Close
Smithfield 4878

www.qldkithomes.com.au
luke@qldkithomes.com.au

PH. 4038 3900



Ideal for Sloped Blocks



Enjoy outdoor living



Contemporary Design